

MaxMotion

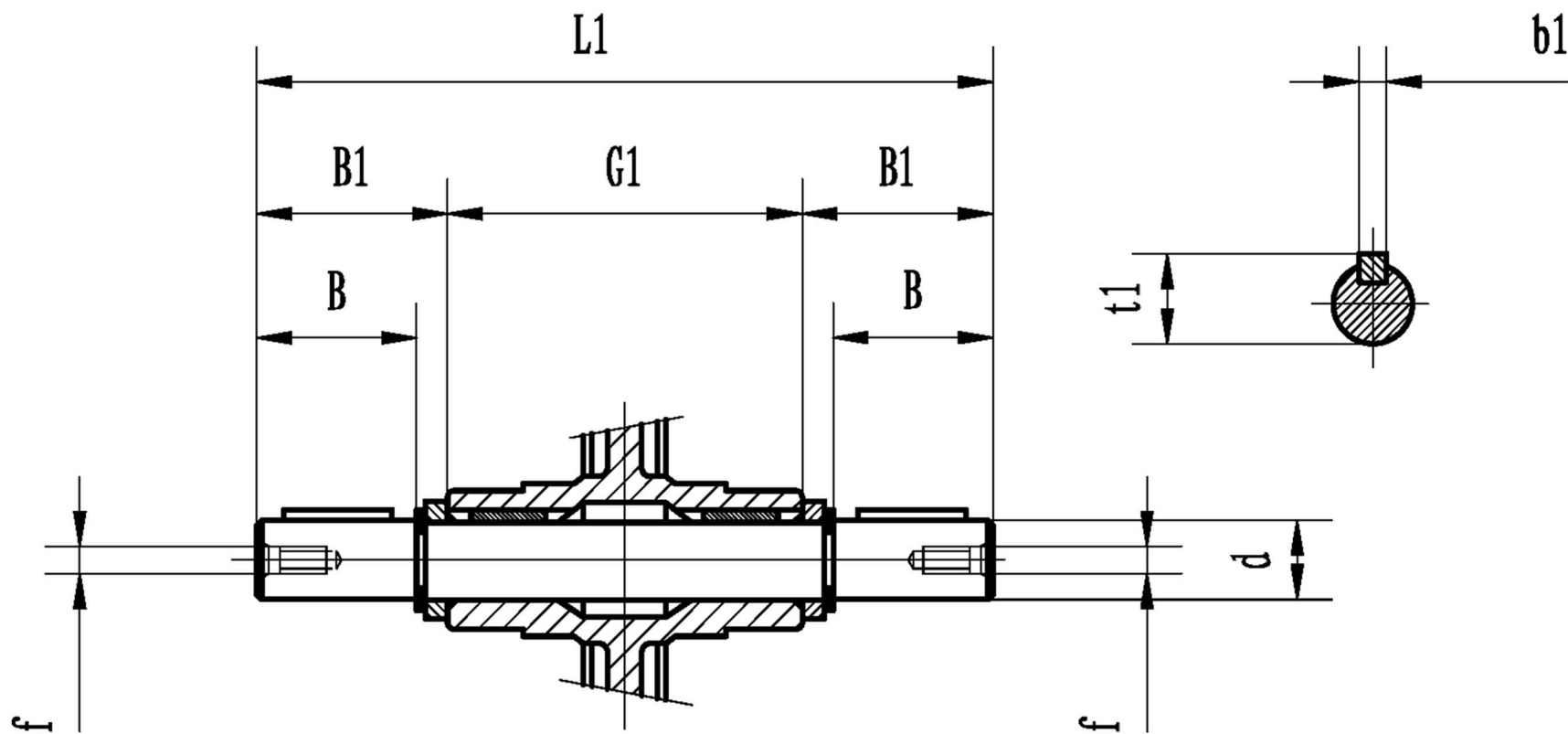

Customer is responsible in determining that MEP product will fit/perform suitably in the intended application

Version: 2HAN

Revised: 11-04-2025

| SIZE | B | d | f | L1 | B1 | b1 | G1 | t1 |
|------|------|------|-----------|-------|------|--------|------|------|
| 75 | 2.76 | 1.22 | 1/2-13UNC | 10.55 | 2.76 | 0.2362 | 4.88 | 1.10 |

MRS75-DOUBLE OUTPUT SHAFT